

CS-10A Cast Steel Globe Valve Flanged, Class-600

Product Description

HSN 84818030

Product : Sant Cast Steel Globe Valve
 Product Standard : BS 1873
 Pressure / Class Rating : Class 600
 Body Material cum standard : CCS (ASTM A-216 Gr. WCB)
 Product Description : Bolted Bonnet O/S Yoke Type Rising Stem
 Type of Seat : Renewable
 Type of Disc : Renewable Disc
 Trim : SS AISI-410
 End Details : Flanges as per ASME B 16.5 Class 600 RF Undrilled



Testing & Certification

Body Test Pressure : 153 Barg (2220 Psig.) Hyd.
 Seat Test Pressure : 112 Barg (1630 Psig.) Hyd. 6.9barg
 100 Psig. (AIR)

Our Works' Test Certificate is furnished with every supply.

Materials of Construction

Components	Materials	Specifications
Body, Bonnet, Disc, Gland Flange	C.C.S.	ASTM A216 Gr. WCB
Stem, Back Seat Bush, Body Seat Ring, Valve Disc Ring, Gland Follower, Lantern Ring & Thrust Plate	Stainless Steel	AISI-410
Gasket	Spiral Wound S.S. 304 with Graphite Filler	—
Gland Packing	Expanded Pure Flexible Graphite	—
Fasteners	Mild Steel	—
Yoke Bush	Aluminum Bronze	—
Handwheel	S.G. Iron	—

Dimensions (in mm)

Nominal Size	Nominal Size (Inches)	F±2	H (Approx.)	ØW (Approx.)
40	1.1/2	242	305	200
50	2	292	360	254
65	2.1/2	330	405	305
80	3	356	450	305
100	4	432	525	450
150	6	559	670	560
200	8	660	740	600

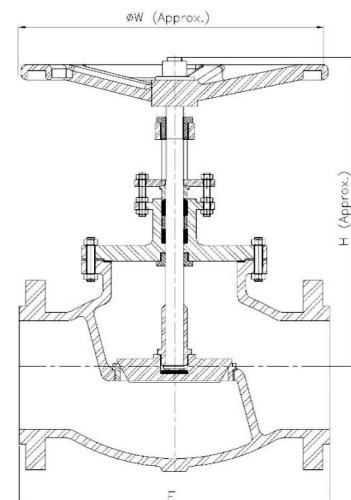

Notes

1. Product images are for illustration purposes only. Actual product may vary.

2. Actual dimensions may change over time, due to continual design improvements. Please confirm before placing order.