

## CS-8A Cast Steel Horizontal Check Valve Flanged, Class-300

### Product Description

HSN 84813000

Product : Sant Cast Steel Swing Check Valve  
 Product Standard : Conforming to BS 1868/ANSI B 16.34  
 Body Material cum standard : CCS (ASTM A-216 Gr. WCB)  
 Product Description : Bolted Cover  
 Type of Seat : Renewable Seat  
 Type of Disc : Renewable Disc  
 Hinge Pin : AISI 410 Stainless Steel  
 End Details : Flanges as per ASME B 16.5 Class-300 R.F. Undrilled

### Testing & Certification

Body Test Pressure : 76barg Hyd. (435Psig.)  
 Seat Test Pressure : 56barg Hyd. (320Psig.)

Our Works' Test Certificate is furnished with every supply.



### Materials of Construction

Components	Materials	Specifications
Body, Cover	C.C.S.	ASTM A216 Gr. WCB
Studs & Nuts	Alloy Steel & H.T Steel	ASTM A193 Gr. B7 & ASTM A194 Gr. 2H
Disc	S.S.	ASTM A276 Type 410
Gasket	Spiral Wound S.S 304 With Asbestos Filler	—
Body Seat Ring	S.S. /F.S.S	ASTM A276 Type 410/ ASTM A182 Gr. F6a

### Dimensions (in mm)

Nominal Size	Nominal Size (Inches)	F±2	H
25	1	203	95
32	1.1/4	216	100
40	1.1/2	229	110
50	2	267	120
65	2.1/2	292	176
80	3	318	185
100	4	356	215
150	6	445	246
200	8	559	265
250	10	622	340
300	12	711	395

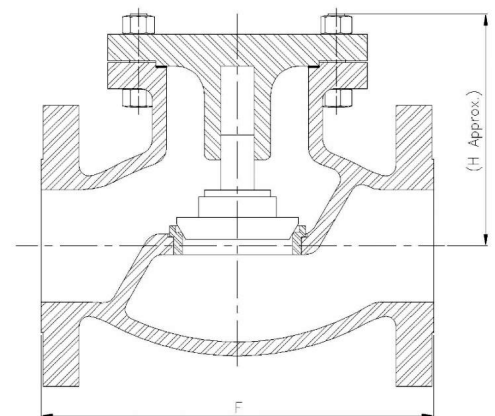

### Notes

1. Product images are for illustration purposes only. Actual product may vary.
2. Actual dimensions may change over time, due to continual design improvements. Please confirm before placing order.