

IBR-4A Bronze Vertical Lift Check Valve Screwed Ends (IBR Approved)

Product Description

HSN 84813000

Product : 'SANT' Bronze Vertical Non Return Valve
Type of Pattern : Vertical Type
Body Material cum Standard : Bronze IBR 282(a)(iv) Gr.B
Description : Two piece design
Type of Seat : Renewable Seat
Type of Disc : Renewable Disc
Trim : SS AISI-410
End Details : Screwed female BSP Taper threads to BS 21

Testing & Certification

Body Test Pressure : 500 Psig. Hyd.
Seat Test Pressure : 500 Psig. Hyd. & 250 Psig. Steam
Working Pressure : Max.BOP 250 Psig.(17.58Kg/cm²)
Maximum Working Temperature: 225°C (435°F)

Test Certificate in Form III-C as per IBR is furnished with every supply.

Application

| | | |
|-------|-----|-------|
| Water | Oil | Steam |
|-------|-----|-------|



Materials of Construction

| Components | Materials | Specifications |
|-----------------------------|-----------------|---------------------|
| Body | Bronze | IBR 282(a)(iv) Gr.B |
| Body Seat Ring & Valve Disc | Stainless Steel | AISI-410 |

Dimensions (in mm)

| Nominal Size | Nominal Size (Inches) | F |
|--------------|-----------------------|---------|
| 15 | 1/2 | 73±1.5 |
| 20 | 3/4 | 76±1.5 |
| 25 | 1 | 90±1.5 |
| 32 | 1.1/4 | 114±1.5 |
| 40 | 1.1/2 | 127±1.5 |
| 50 | 2 | 146±1.5 |

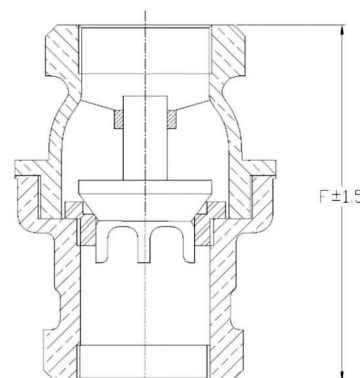

Notes

- Product images are for illustration purposes only. Actual product may vary.
- Actual dimensions may change over time, due to continual design improvements. Please confirm before placing order.