

IBR-3E Bronze Horizontal Lift Check Valve Bolted Cover, Flanged Ends (IBR Approved)

Product Description

HSN 84813000

Product : 'SANT' Bronze Horizontal Lift Check Valve
 Type of Pattern : Straight Type
 Body Material cum Standard : Bronze IBR 282(a)(iv) Gr.B
 Description : Bolted cover
 Type of Seat : Renewable Seat
 Type of Disc : Renewable Disc
 Trim : SS AISI-410
 End Details : Flanges as per BS 10 Table F F.F. undrilled



Testing & Certification

Body Test Pressure : 300 Psig.Hyd.
 Seat Test Pressure : 300 Psig. Hyd. & 150 Psig. Steam
 Working Pressure : Max.BOP 150 Psig.(10.54Kg/cm²)
 Maximum Working Temperature: 225°C (435°F)

Test Certificate in Form III-C as per IBR is furnished with every supply.

Application

| | | |
|-------|-----|-------|
| Water | Oil | Steam |
|-------|-----|-------|

Materials of Construction

| Components | Materials | Specifications |
|-----------------------------|-----------------|---------------------|
| Body, Bonnet | Bronze | IBR 282(a)(iv) Gr.B |
| Body Seat Ring & Valve Disc | Stainless Steel | AISI-410 |
| Gasket | CAF | IS:2712 Gr.C |
| Fasteners | Mild Steel | — |

Dimensions (in mm)

| Nominal Size | Nominal Size (Inches) | F | H (Approx.) |
|--------------|-----------------------|---------|-------------|
| 40 | 1.1/2 | 143±1.5 | 105 |
| 50 | 2 | 171±1.5 | 125 |
| 65 | 2.1/2 | 225±1.5 | 131 |
| 80 | 3 | 264±1.5 | 140 |
| 100 | 4 | 289±1.5 | 165 |

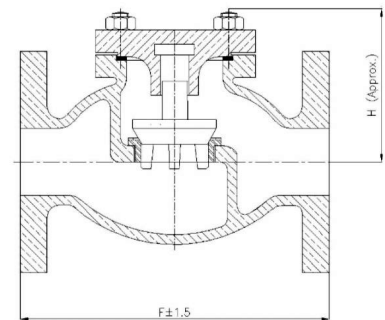

Notes

- Product images are for illustration purposes only. Actual product may vary.
- Actual dimensions may change over time, due to continual design improvements. Please confirm before placing order.