

IBR-2B Bronze Globe Steam Stop Valve OS & Yoke Type, Flanged Ends (IBR Approved)

Product Description

HSN 84818030

Product : 'SANT' Bronze Globe Steam Stop Valve
 Type of Pattern : Straight Type
 Body Material cum Standard : Bronze IBR 282(a)(iv) Gr.B
 Description : Bolted Bonnet, Outside Screw & Yoke Type, Rising Stem
 Type of Seat : Renewable Seat
 Type of Disc : Renewable Disc
 Trim : SS AISI-410
 Gland Packing : Expanded Pure Flexible Graphite
 End Details : Flanges as per BS 10 Table H F.F. undrilled



Testing & Certification

Body Test Pressure : 500 Psig.Hyd.
 Seat & Back Seat Test Pressure : 500 Psig. Hyd. & 250 Psig. Steam
 Working Pressure : Max.BOP 250 Psig.(17.58Kg/cm²)
 Maximum Working Temperature: 225°C (435°F)

Test Certificate in Form III-C as per IBR is furnished with every supply.

Application

Water	Oil	Steam
-------	-----	-------

Materials of Construction

Components	Materials	Specifications
Body, Bonnet, Disc Nut, Gland	Bronze	IBR 282(a)(iv) Gr.B
Stem, Body Seat Ring & Valve Disc	Stainless Steel	AISI-410
Handwheel	C.I. / D.I.	IBR 86 to 93 Gr.A
Gland Packing	Expanded Pure Flexible Graphite	—
Fasteners, Washer & Nut for Handwheel	Mild Steel	—

Dimensions (in mm)

Nominal Size	Nominal Size (Inches)	F	H (Approx.)	ØW (Approx.)
15	1/2	102±1.5	125	70
20	3/4	114±1.5	125	70
25	1	127±1.5	165	90
32	1.1/4	140±1.5	200	90
40	1.1/2	152±1.5	220	127
50	2	178±1.5	250	144
65	2.1/2	229±1.5	270	178
80	3	267±1.5	325	197
100	4	292±1.5	345	229

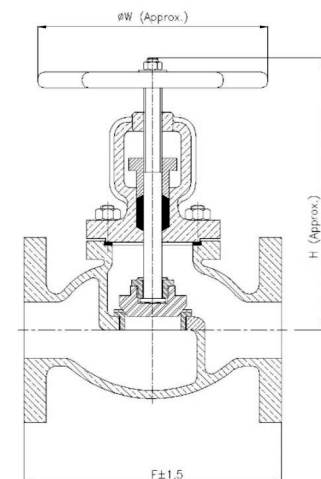

Notes

- Product images are for illustration purposes only. Actual product may vary.
- Actual dimensions may change over time, due to continual design improvements. Please confirm before placing order.