

IBR-1A Bronze Globe Steam Stop Valve Screwed Ends (IBR Approved)

Product Description

HSN 84818030

Product : 'SANT' Bronze Globe Steam Stop Valve
Type of Pattern : Straight Type
Body Material cum Standard : Bronze IBR 282(a)(iv) Gr.B
Description : Screwed in Bonnet, Inside Screw, Rising Stem
Type of Seat : Renewable Seat
Type of Disc : Renewable Disc
Trim : SS AISI-410
Gland Packing : Expanded Pure Flexible Graphite
End Details : Screwed female BSP Taper threads to BS 21

Testing & Certification

Body Test Pressure : 500 Psig.Hyd.
Seat & Back Seat Test Pressure : 500 Psig. Hyd. & 250 Psig. Steam
Working Pressure : Max.BOP 250 Psig.(17.58Kg/cm²)
Maximum Working Temperature: 225°C (435°F)

Test Certificate in Form III-C as per IBR is furnished with every supply.

Application

Water	Oil	Steam
-------	-----	-------



Materials of Construction

Components	Materials	Specifications
Body, Bonnet, Disk Nut, Gland & Gland Nut	Bronze	IBR 282(a)(iv) Gr.B
Body Seat Ring, Valve Disc & Spindle	Stainless Steel	AISI-410
Handwheel	C.I. / D.I.	IBR 86 to 93 Gr.A
Gland Packing	Expanded Pure Flexible Graphite	—
Locking Washer	Brass Sheet	—
Washer & Nut for Handwheel	Mild Steel	—

Dimensions (in mm)

Nominal Size	Nominal Size (Inches)	F	H (Approx.)	ØW(Approx.)
8	1/4	75±1.5	111	70
10	3/8	75±1.5	115	70
15	1/2	83±1.5	125	70
20	3/4	95±1.5	125	70
25	1	111±1.5	152	90
32	1.1/4	133±1.5	172	90
40	1.1/2	152±1.5	181	127
50	2	178±1.5	215	144

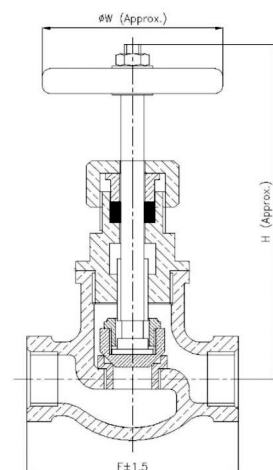

Notes

- Product images are for illustration purposes only. Actual product may vary.
- Actual dimensions may change over time, due to continual design improvements. Please confirm before placing order.