

CIBFP C.I. Butterfly Valve with Pneumatic Actuator Wafer Type, PN 10/PN 16

Product Description

HSN 84818030

Product : Sant C.I. Butterfly Valve with Pneumatic Actuator
 Type of Pattern : Water Type
 Pressure/Class/Rating : PN 10/PN 16
 Body Material Cum Standard : CI to IS:210 Gr FG200
 Product Description : Wafer Type
 Type of Seat : Nitrile/EPDM Lining
 Type of Disc : Stainless Steel CF8
 Stem : AISI-410
 End Details : Suitable insertion between flanges as per BS 10 Table F/D/E or ASME B 16.1 Class-125



Testing & Certification

Ratings:

PN10

Body Test Pressure : 1.5MPa (218 Psig) Hyd

Seat Test Pressure : 1.1MPa (160 Psig) Hyd

PN16

Body Test Pressure : 2.4MPa (348 Psig) Hyd

Seat Test Pressure : 1.8MPa (261 Psig) Hyd

Materials of Construction

Components	Materials	Specifications
Bush	PTFE	
Body	Cast Iron	IS:210:Gr.FG200
Upper Stem	SS	AISI-410
Cover Plate	Carbon Steel	
Body Lining	EPDM/Nitrile Rubber	
Disc	SS	CF8
Lower Stem	SS	AISI-410
Locking Screw	Steel	
Bolts & Nuts	Carbon Steel	
Pneumatic Actuator		

Dimensions (in mm)

Size	F	D
40	33	85
50	43	95
65	46	110
80	46	124
100	52	152
125	56	179
150	56	207
200	60	260

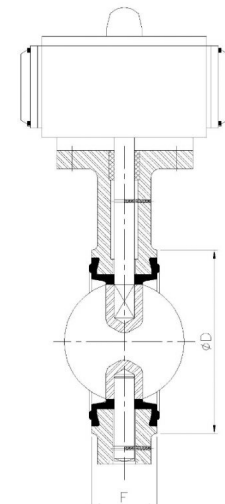

Notes

1. Product images are for illustration purposes only. Actual product may vary.
2. Actual dimensions may change over time, due to continual design improvements. Please confirm before placing order.