

## FSV-2B Forged Steel Globe Valve Reduced Bore, Class 800, Socket Welded Ends (IBR Approved)

### Product Description

HSN 84818030

Product : 'SANT' Forged Steel Globe Valve  
 Product Standard : BS 5352 / API 602  
 Pressure / Class / Rating : Class 800  
 Body Material cum Standard : FCS (A105)  
 Description : Bolted Bonnet, Outside Screw & Yoke Type, Rising Stem  
 Type of Seat : Renewable Seat  
 Type of Disc : Renewable Disc  
 Trim : SS AISI-410  
 Gland Packing : Expanded Pure Flexible Graphite  
 Fastener & Gasket : Alloy Steel (Gr.B7/2H) Spiral Wound SS 304 (CAF/Graphite filled)  
 End Details : Socket Welded Ends as per ASME B-16.11



### Testing & Certification

Body Test Pressure : 207 Bar g (3000 Psig) Hyd.  
 Seat Test Pressure : 152 Bar g (2200 Psig) Hyd. & 6.9 Bar g (100 Psig) Air  
 Maximum Working Temperature : 425°C

Test Certificate in Form III-C as per IBR is furnished with every supply

### Application

|       |     |       |
|-------|-----|-------|
| Water | Oil | Steam |
|-------|-----|-------|

### Materials of Construction

| Components  | Materials  | Specifications  |
|---|--|-----------------|
| Body, Bonnet, Gland Flange                                    | Drop Forged C. Steel   | ASTM A105       |
| Body Seat Ring, Disc, Gland, Stem, Gland Eye Bolts, Yoke Bush | Stainless Steel  | AISI-410        |
| Gland Packing   | Expanded Pure Flexible Graphite                              | —               |
| Gasket  | Spiral Wound SS (AISI-304) Asbestos Filled / Graphite Filled | —               |
| Handwheel   | Malleable Iron / D.I.  | IS:14329        |
| Studs / Bolts   | Alloy Steel  | ASTM A193 Gr.B7 |
| Nuts  | High Tensile Steel   | ASTM A194 Gr.2H |
| Gland Nuts, Screw, Wheel Nuts & Washer                        | Mild Steel   | —               |

### Dimensions (in mm)

| Nominal Size | Nominal Size (Inches) | F     | H(Approx) | W(Approx) | A (Min.) | B (Min.) | B (Max.) |
|--------------|-----------------------|-------|-----------|-----------|----------|----------|----------|
| 10           | 3/8                   | 73±2  | 143       | 86        | 10       | 17.6     | 18       |
| 15           | 1/2                   | 73±2  | 143       | 86        | 10       | 21.8     | 22.2     |
| 20           | 3/4                   | 80±2  | 146       | 86        | 13       | 27.1     | 27.5     |
| 25           | 1                     | 100±2 | 171       | 116       | 13       | 33.8     | 34.2     |
| 40           | 1.1/2                 | 145±2 | 199       | 150       | 13       | 48.6     | 49.1     |
| 50           | 2                     | 160±2 | 236       | 150       | 16       | 61.1     | 61.6     |

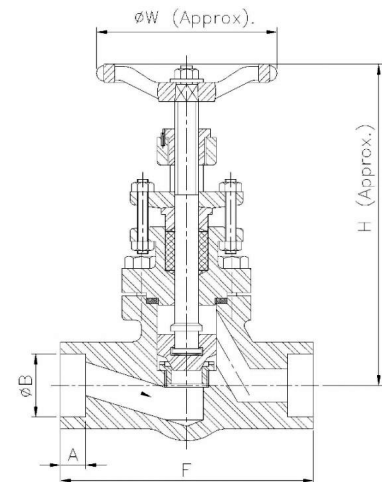

Notes

1. Product images are for illustration purposes only. Actual product may vary.
2. Actual dimensions may change over time, due to continual design improvements. Please confirm before placing order.