

CR-31 Cast Iron Reflux Valve (Swing Check Type) Non Return Valve, Straight Type

Product Description

HSN 84813000

Product : 'SANT' Cast Iron Reflux Valve, Swing Check Type (Non Return Valve)
Pressure Rating: PN10
Product Standard : IS:5312
Type of Pattern : Straight Type
Body Material cum Standard : Cast Iron IS:210 Gr.FG200
Description : Bolted Cover
Type of Seat : Integral / Renewable seat
Type of Disc : Renewable disc
End Details : Flanges as per IS:1538

Testing & Certification

Body Test Pressure : 1.5 MPa Hyd.
Seat Test Pressure : 1.0 MPa Hyd.

Our Works' Test Certificate is furnished with every supply.

Application

Water

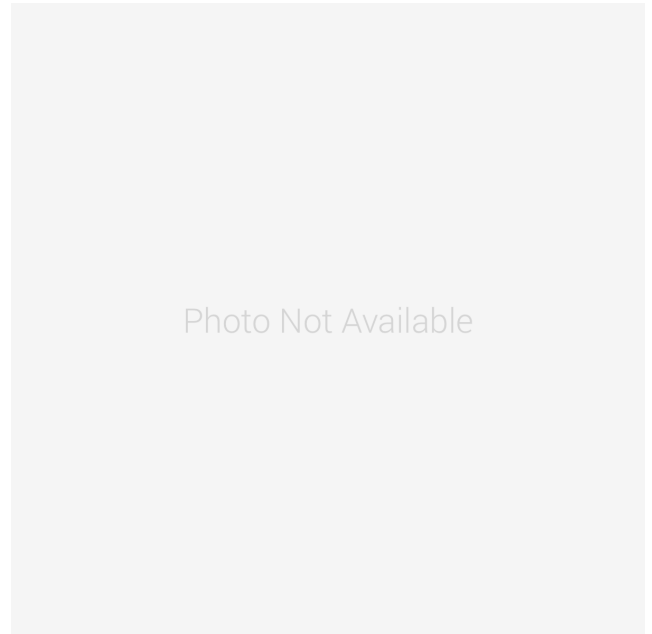

Materials of Construction

Components	Materials	Specifications
Body, Cover, Hinge, Disc	Cast Iron	IS:210 Gr.FG200
Bolts & Nuts	Carbon Steel	IS:1363 PART 1/3
Gasket	Rubber	IS:638 Type B
Hinge Pin	Stainless Steel	AISI-410
Disc Facing	Rubber	IS:638 Type B
Body Seat Ring	Leaded Tin Bronze	IS:318 Gr.LTB2
Stud & Nut	M.S.	—

Dimensions (in mm)

Nominal Size	Nominal Size (Inches)	F	H (Approx.)
50	2	203±2	135
65	2.1/2	216±2	150
80	3	241±2	160
100	4	292±3	185
125	5	330±3	225
150	6	356±3	240
200	8	495±3	292
250	10	622±4	340
300	12	698±4	398

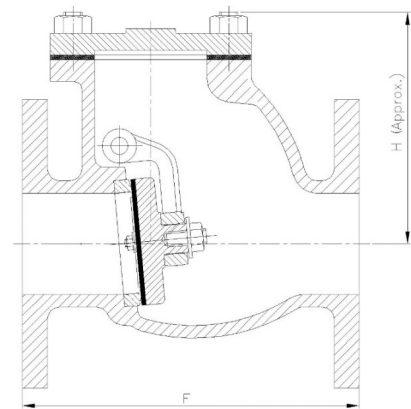

Notes

1. Product images are for illustration purposes only. Actual product may vary.

2. Actual dimensions may change over time, due to continual design improvements. Please confirm before placing order.