

CI-5B Cast Iron Accessable Feed Check Valve Flanged, without Inspection Branch (IBR Approved)

Product Description

HSN 84813000

Product : 'SANT' Cast Iron Accessable Feed Check Valve
 Type of Pattern : Right Angle
 Body Material cum Standard : Cast Iron IBR 86 to 93 Gr.A
 Description : Curved Inlet without Inspection Branch
 Type of Seat : Renewable seat
 Type of Disc : Renewable disc
 Trim : SS AISI-410
 Gland Packing : Expanded Pure Flexible Graphite
 End Details : Flanges as per BS 10 Table F F.F. undrilled

Testing & Certification

TABLE - F

Body Test Pressure : 21.09Kg/cm²
 Seat & Backseat Test Pressure : 10.54Kg/cm²
 Working Pressure : Max BOP 10.54Kg/cm² (150 Psig.) at 220°C Steam

Test Certificate in Form III-C as per IBR is furnished with every supply.

Application

Water	Steam
-------	-------

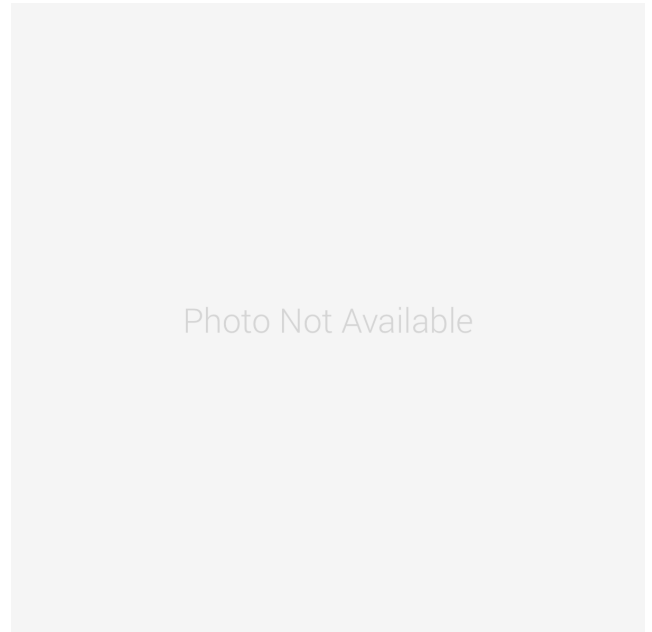

Materials of Construction

Components	Materials	Specifications
Body, Bonnet, Valve Disc, Gland & Handwheel	Cast Iron	IBR 86 to 93 Gr.A
Body Seat Ring, Valve Disc Rings & Check Nut	Stainless Steel	AISI-410
Stopper & Drain Plug	Bronze	IBR 282(a)(iv) Gr.B
Gasket	Compressed Asbestos Fiber	IS:2712 Gr.C
Gland Packing	Expanded Pure Flexible Graphite	—
Fasteners	Mild Steel	—
Yoke Bush	Bronze	—

Dimensions (in mm)

Nominal Size	Nominal Size (Inches)	A	B±2	C	F	G±2	ØW
25	1	188	220	180	95	100	125
32	1.1/4	209	240	190	105	150	125
40	1.1/2	235	260	200	110	115	160
50	2	255	280	210	120	125	160
65	2.1/2	300	300	250	130	145	200

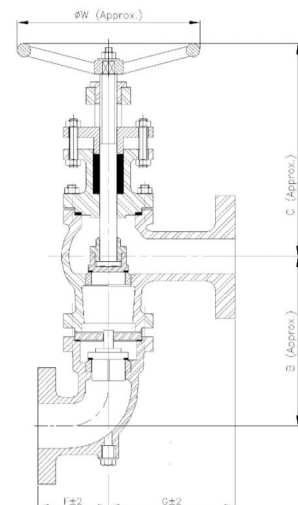

Notes

1. Product images are for illustration purposes only. Actual product may vary.

2. Actual dimensions may change over time, due to continual design improvements. Please confirm before placing order.