

## CI-4A Cast Iron Right Angle Lift Check Valve Flanged (IBR Approved)

### Product Description

HSN 84813000

Product : 'SANT' Cast Iron Right Angle Lift Check Valve  
 Product Standard : BS:5153  
 Type of Pattern : Right Angle  
 Pressure / Class / Rating : PN 16  
 Body Material cum Standard : Cast Iron IBR 86 to 93 Gr.A  
 Description : Bolted Cover  
 Type of Seat : Renewable seat  
 Type of Disc : Renewable disc  
 Trim : SS AISI-410  
 End Details : Flanges as per DIN 2533 RF (PN 16) Undrilled



### Testing & Certification

Rating : PN 16  
 Body Test Pressure : 26Kg/cm<sup>2</sup>g (Hyd.)  
 Seat Test Pressure : 16Kg/cm<sup>2</sup>g (Hyd.)  
 Working Pressure : Max BOP 13Kg/cm<sup>2</sup>g at 220°C Steam

Test Certificate in Form III-C as per IBR is furnished with every supply.

### Application

Water	Steam
-------	-------

### Materials of Construction

Components	Materials	Specifications
Body, Bonnet, Valve Disc	Cast Iron	IBR 86 to 93 Gr.A
Body Seat Ring, Valve Disc Ring	Stainless Steel	AISI-410
Gasket	Compressed Asbestos Fiber	IS:2712 Gr.C
Fasteners	Mild Steel	—

### Dimensions (in mm)

Nominal Size	Nominal Size (Inches)	F ±2	H (Approx)
15	1/2	90	60
20	3/4	95	60
25	1	100	60
32	1.1/4	105	70
40	1.1/2	115	80
50	2	125	85
65	2.1/2	145	100
80	3	155	110
100	4	175	115
125	5	200	130
150	6	225	150
200	8	275	175

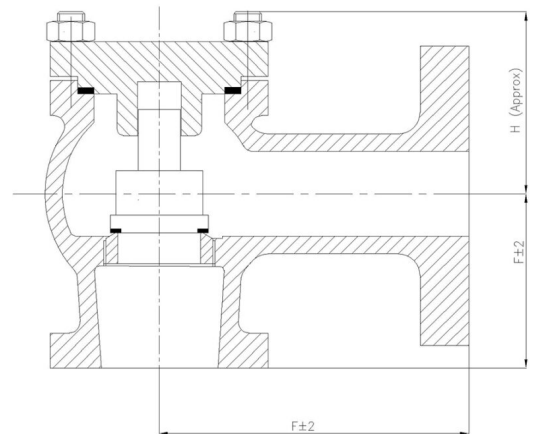

### Notes

- Product images are for illustration purposes only. Actual product may vary.
- Actual dimensions may change over time, due to continual design improvements. Please confirm before placing order.