

Concentric Reducer (Threaded) XGQT07S

Product Description

Product Certification

UL Listed / FM Approved

Material of Construction

Ductile Iron as per ASTM A536 Gr. 65 - 45 - 12

Pressure Rating

Test Pressure : 12.5 MPa

Max. Working Pressure : 2.5 MPa

Please note that as per FM 1920:2007 Sizes <= 150 mm are rated PN20 and > 150 mm are rated PN16

Nuts & Bolts

Heat Treated Carbon Steel as per ISO 898-1 Class 8.8

Finishing

Epoxy Red Paint RAL - 3000/3001

Branch Outlets

Threaded Branch Outlets as per BSPT ISO 7-1



Dimensions (in mm)

Nominal Size	Nominal Size (Inch)	Pipe O.D.	L
50×25	2×1	60.3×33.7	64
50×32	2×1.1/4	60.3×42.4	64
50×40	2×1.1/2	60.3×48.3	64
65×25	2.1/2×1	76.1×33.7	64
65×32	2.1/2×1.1/4	76.1×42.4	64
65×40	2.1/2×1.1/2	76.1×48.3	64
65×50	2.1/2×2	76.1×60.3	64
80×25	3×1	88.9×33.7	64
80×32	3×1.1/4	88.9×42.4	64
80×40	3×1.1/2	88.9×48.3	64
80×50	3×2	88.9×60.3	64
80×65	3×2.1/2	88.9×76.1	64
100×25	4×1	114.3×33.7	76
100×32	4×1.1/4	114.3×42.4	76
100×40	4×1.1/2	114.3×48.3	76
100×50	4×2	114.3×60.3	76
100×65	4×2.2/1	114.3×76.1	76
100×80	4×3	114.3×88.9	76
125×25	5×1	139.7×33.7	102
125×32	5×1.1/4	139.7×42.4	102
125×40	5×1.1/2	139.7×48.3	102
125×50	5×2	139.7×60.3	102
125×65	5×2.1/2	139.7×76.1	102
125×80	5×3	139.7×88.9	102
125×100	5×4	139.7×114.3	102
150×25	6×1	165.1×33.7	102
150×32	6×1.1/4	165.1×42.4	102
150×40	6×1.1/2	165.1×48.3	102
150×50	6×2	165.1×60.3	102

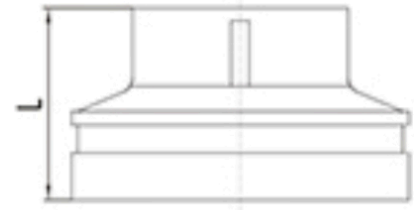

Nominal Size	Nominal Size (Inch)	Pipe O.D.	L
150×65	6×2.1/2	165.1×76.1	102
150×80	6×3	165.1×88.9	102
150×100	6×4	165.1×114.3	102
200×25	8×1	219.1×33.7	127
200×32	8×1.1/4	219.1×42.4	127
200×40	8×1.1/2	219.1×48.3	127
200×50	8×2	219.1×60.3	127
200×65	8×2.1/2	219.1×76.1	127
200×80	8×3	219.1×88.9	127
200×100	8×4	219.1×114.3	127