

Reducing Tee

Product Description

Product Standard

As per IS:1239 (PART2): 1992 Screwed BSP Ends.

The carbon steel used in drop forged steel pipe fittings contains sulphur and phosphorus not exceeding 0.06% each.

End Connections

Screwed Female Ends conform to BSP as per BS21 / IS:554.

Other types of threads i.e. NPT can be given on request.

Test Pressure

IS:1239 (PART2) 1992-Pipe Fittings are tested to 1000 psig. (Hyd.)



Dimensions (in mm)

Nominal Size of Outlet	Minimum Length Center to Face (A)	Minimum Length Center to Face (B)
8×6	21	22
10×6	21	24
10×8	22	24
15×8	25	32
15×10	27	32
20×8	27	35
20×10	29	35
20×15	32	35
25×10	30	43
25×8	32	43
25×15	35	43
25×20	38	43
32×10	35	51
32×15	38	51
32×20	41	51
32×25	44	51
40×10	37	52
40×15	38	52
40×20	41	52
40×25	49	52
40×32	49	52
50×15	41	64
50×20	44	64
50×25	48	64
50×32	52	64
50×40	56	64
65×25	54	76
65×32	57	76

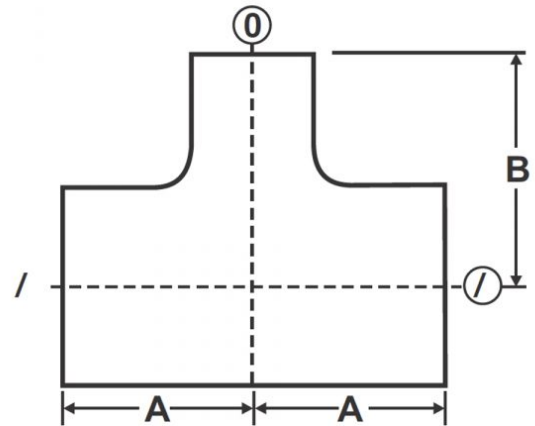

Nominal Size of Outlet	Minimum Length Center to Face (A)	Minimum Length Center to Face (B)
65×40	60	76
65×50	67	76
80×25	60	89
80×32	64	89
80×40	67	89
80×50	73	89
80×65	79	89